

The greek odyssey

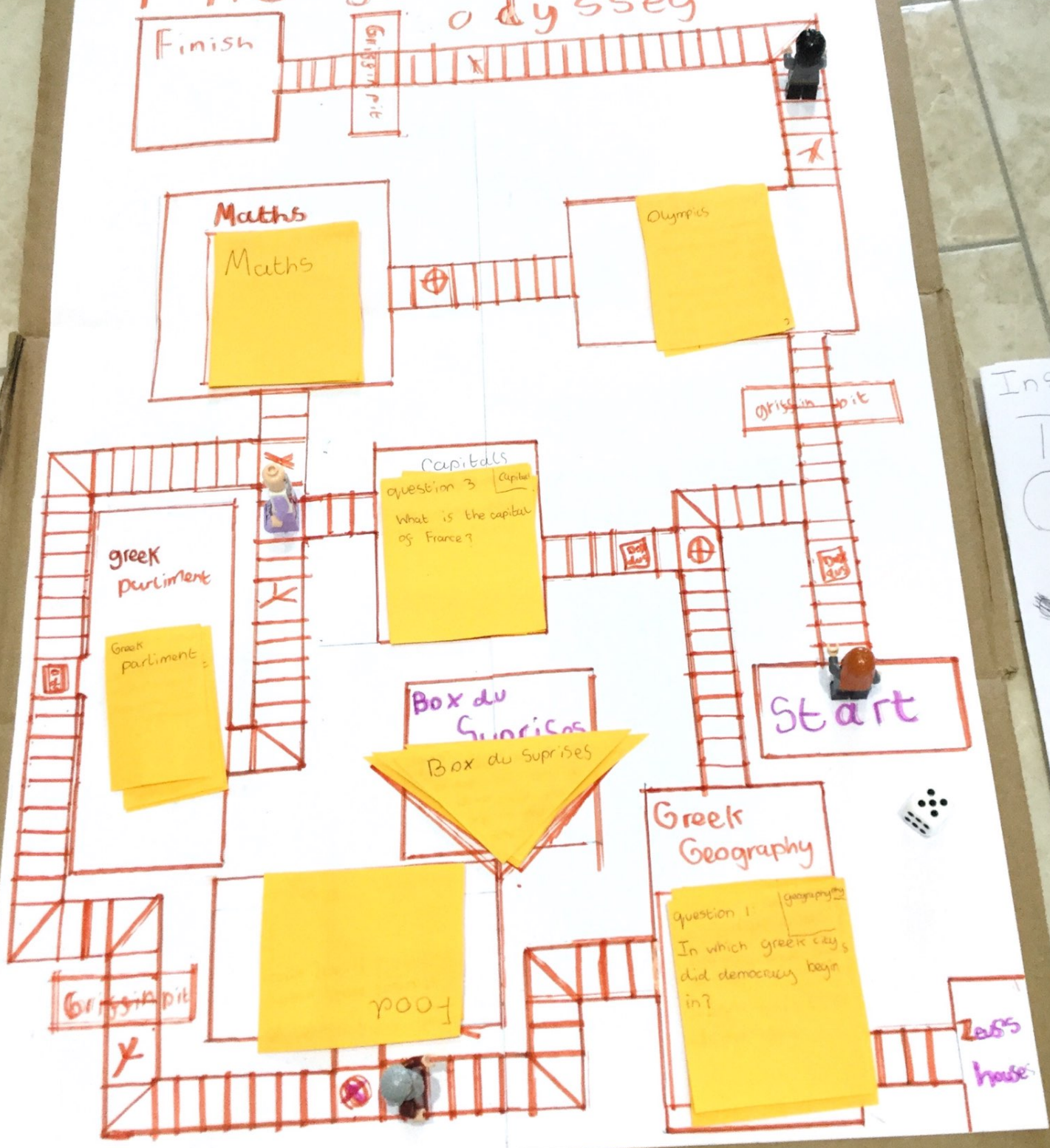

Ins
|
○

Instructions for THE GREEK ODYSSEY



How to play:

- Put all the characters on 'Start', you are only allowed to get out of 'start' once you have got a six. The first person rolls the dice. Once someone has got a six that person moves forward one space on the board and it is the next person's turn. When you are rolling there are dangers to look out for. If you land on \oplus , you go to Zeus's house and miss a go. If you land on \times you lose your cards and go to the start and if you land on \square every theme but box de surprises (you can go there if you want to) and win a card. To win a card you turn the card and answer the question. To check if you get it right or wrong there is an answer card at every theme. Once you have collected all the cards you go to finish.
- If you get the question wrong, you stay where you are and pick a new card and on your next go answer the question. Carry on until you get it right. If you get it right, collect the card and move on. You are not allowed to get 2 cards from the same theme.

Answer Sheet

Geography:

1. Athens
2. Aegean sea
3. Pindos mountains
4. Thessaloniki
5. blue and white
6. d

olympics

1. BC ~~700~~
2. 1896 + 2004
3. True
4. ~~28~~
- ~~5.~~

Maths

1. 52
2. 111
3. ~~822~~
4. 54
5. 1,029

Parliament^a

1. Democracy, monarchy and Oligarchy
2. Democracy
3. Athens
4. Sparta
5. Corinth

Capitals

1. Tehran
2. Fiji
3. Paris
4. China
5. ~~Washington DC~~

Food

1. Greece
2. Italy
3. Germany
4. Spain
5. England